

# BL VALVE

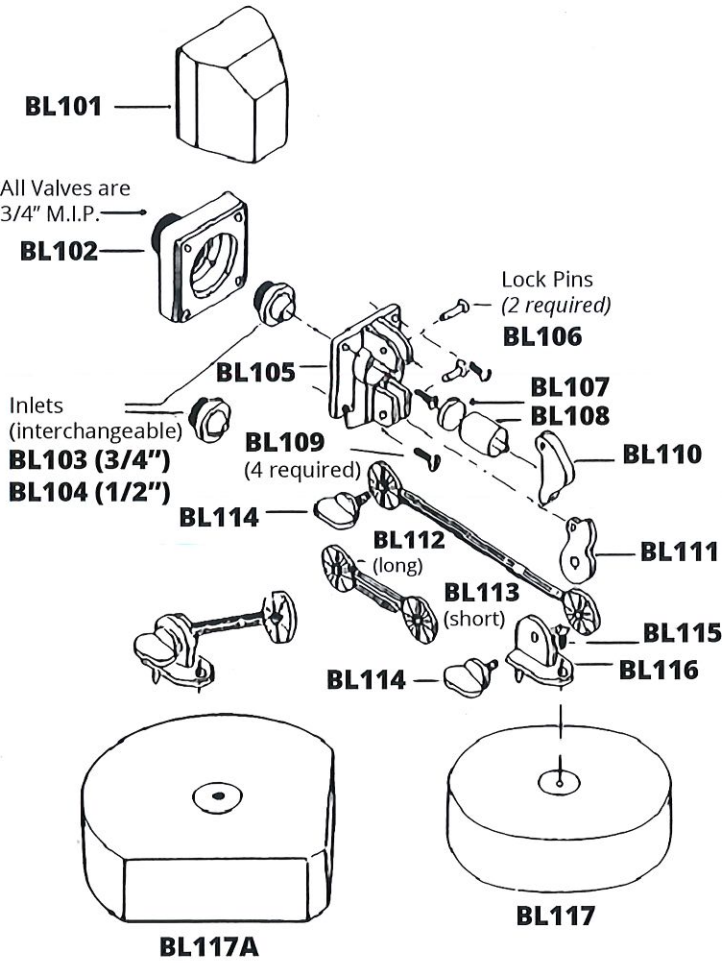

All Valves are 3/4" Hook-Up

- BL119**  
3/4" Complete Valve Arm & BL117, BL117A, BL117P Float Assembly 41610
- BL120**  
1/2" Complete Valve Arm & BL117, BL117A, BL117P Float Assembly 41611
- BL121**  
1/2" Complete Less Float & Arm Assembly 41612
- BL122**  
3/4" Complete Less Float & Arm Assembly 41613
- BL101**  
Cap 41614
- BL102**  
Bottom Base 41615
- BL103**  
3/4" Inlet 41616
- BL104**  
1/2" Inlet 41617
- BL105**  
Top Base 41618
- BL106**  
Lock Pin (2 Required) 41619
- BL107**  
Plunger Seat 41620
- BL108**  
Plunger 41621
- BL109**  
Base Screw (4 Required) 41622
- BL110**  
Upper Arm 41623
- BL111**  
Lower Arm 41624
- BL112**  
Long Valve Arm 41625
- BL113**  
Short Valve Arm 41626
- BL114**  
Thumb Screw 41627
- BL115**  
Float Screw 41629
- BL116**  
Float Connect 41630
- BL117**  
Round Float 41631
- BL117A**  
Cut-Off Float 41632
- BL117P**  
Poly-Float 41633
- Drain Plugs**  
(All Models) 41636



**3-Foot Walk-Through Oiler**  
Item No. 49010



**6-Foot Walk-Through Oiler**  
Item No. 49030



**MF3 Mineral Feeder**  
Item No. 30080



**Super-10 Bale Feeder**  
Item No. 30018



**Wind Vane Mineral Feeder with Tank**  
Item No. 49001



- 14-Gauge Hog Troughs**
- 2' Trough  
Item No. 51010
- 4' Trough  
Item No. 51020
- 6' Trough  
Item No. 51030
- 8' Trough  
Item No. 51040
- 10' Trough  
Item No. 51050



# FRANKLIN

A MILLS COMPANY

[www.FranklinWaterers.com](http://www.FranklinWaterers.com)

## AG PRODUCTS

### WATERERS BROCHURE

FRANKLIN EQUIPMENT  
405 EAST MARGARET STREET  
EARLVILLE, IA 52041  
(phone) 563-923-2026  
(toll free) 800-422-3561  
(fax) 563-923-2413  
[PKruse@millsgrp.com](mailto:PKruse@millsgrp.com)





# ALL PURPOSE POLY WATERERS

- Floating Lids save 85-90% on Heating Costs
- Floating lids extend the life of the heater 2 to 3 times versus open trough models
- Water stays warmer in the winter and cooler in the summer
- Equipped with our 3/4" M.I.P. BL valve system and spray on foam insulation



## PC-1 Item # 40180

Capacity: 20 head  
80W Element  
Adjustable Thermostat  
40W Heat tape  
24.25"L x 19"W x 18.75"H  
Height to Drink 15.25



## PC-2 Item # 40205

Capacity: 40 head  
80W Element  
Adjustable Thermostat  
40W Heat tape  
33"L x 21"W x 19"H  
Height to Drink 15.75"



## PC-10 Item # 39900

Capacity: 80 head  
2 - 100W Elements  
Adjustable Thermostat  
40W Heat tape  
32.5"L x 25"W x 31.75"H  
Height to Drink 15.75



## AP-1 Item # 40220

Capacity: 0-30 head  
Submersible 250W heater  
40W Heat tape  
27"L x 25.5"W x 23.5"H

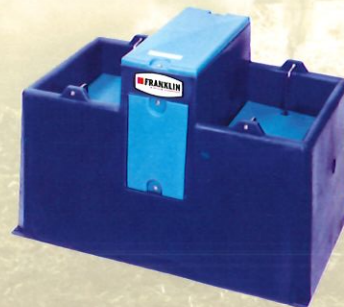

## AP-10 Item # 40170

Capacity: 80-100 Head  
Submersible 250W heater  
40W Heat tape  
40.5"L x 24.75"W x 27.5"H



## P-40 Hog Waterer Item # 48030

Ideal for small pigs, poultry. 6 openings  
Easy to adjust gravity flow valve.  
33" Height 74" Diameter  
Holds approximately 40 gallons



## P-80 Livestock Waterer Item # 47050

Gravity flow valve with 16.75"  
drink openings on each side. Easy to clean  
with a garden hose. Can be heated with a  
stock tank heater suitable for plastic.  
41" H 106" Diameter  
Holds approximately 85 gallons.

# AUTOMATIC FRANKLIN STEEL WATERERS

- Durable construction, economically operated heating units
- All equipped with our 3/4" M.I.P. BL valve system
- Versatile — Use in fence lines or stand alone in feedlots
- Lids can be closed
- Powder-Coated and foam sheet insulation



## F-1 Item # 40855

Low. Compact, general use for horses,  
calves, ponies, sheep, and cattle.  
Capacity of 5-10 head 325 Watts  
29.75"L x 13.75"W x 22.5"H



## F-5 Item # 40630

Low. Compact, general use for horses,  
calves, ponies, sheep, and cattle.  
Capacity of 40 head 610 Watts  
31.75"L x 17.5"W x 30"H



## F-52 Item # 40852

Combination Waterer  
Capacity 40 cattle and  
120 Hogs  
Popular size model for  
medium size operation  
17 1/2" W x 30" H x 32" L  
895 watts



## F-10 Item # 40680

General use for horses.  
One side can be shut down.  
Capacity of 125 head 610 Watts  
41"L x 20"W x 32"H

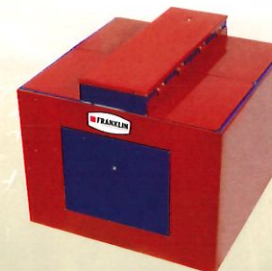

## E-20 Item # 40705

Largest of four upright units.  
The 4 lids can be opened and  
closed as needed.  
Capacity of 250 head 1180 Watts  
37"L x 37"W x 28"H



## F-48 Item # 40730

Designed for large commercial lots.  
Capacity of 100 head 895 Watts  
50.25"L x 20"W x 20.5"H



## F-8 Item # 40655

Designed for large commercial lots  
Capacity of 250 head 1180 Watts  
72'L x 19.5"W x 16.25"H



## H-1 Item # 40480

Franklin's mini Hog waterer.  
Features a large drink opening.  
Designed for restricted areas.  
Capacity 60 head 315 Watts  
17.5"L x 11.25"W x 8.75"H



## H-2 Item # 40505

Franklin's Hog waterer.  
Features two large drink openings.  
Designed for fence line or feed lots.  
Capacity 120 head 315 Watts  
25.75"L x 11.25"W x 8.75"H



## F-100 Item # 40755

Designed for large commercial lots  
Capacity of 450 head 1180 Watts  
108'L x 19.5"W x 16.25"H